

DS-7204/7208/7216HVI-ST Standalone DVR



DS-7208HVI-ST



DS-7204HVI-ST



DS-7216HVI-ST

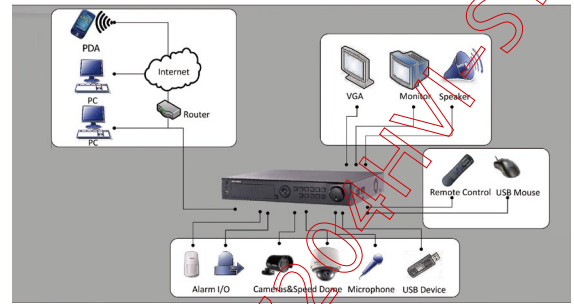

Key features

- H.264 video compression
- Up to 4CIF resolution recording
- VGA output at up to 1280×1024 resolution
- Dual-stream
- 4/8/16-ch synchronous playback
- SMTP, NTP, SADP (IP Finder), DHCP protocols

Rear Panel of DS-7216HVI-ST

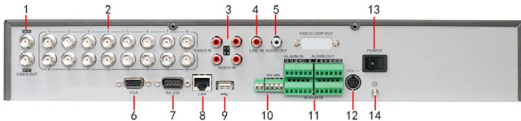

1. Main / spot video out
2. Video in
3. Audio in
4. Line in
5. Audio out
6. VGA interface
7. RS-232 serial interface
8. LAN
9. USB interface
10. RS-485 interface
11. Alarm in, alarm out
12. 12 VDC power supply interface
13. Power switch
14. GND

Specifications

	DS-7204HVI-ST	DS-7208HVI-ST	DS-7216HVI-ST
Video / Audio input			
Video compression	H.264		
Analog video input	4-ch	8-ch	16-ch
Video interface	BNC connector (1.0 Vp-p, 75 Ω); PAL / NTSC self-adaptive		
Audio compression	G.711		
Audio input	4-ch, RCA connector (2.0 Vp-p, 1 kΩ)		
Voice talk input	1-ch, RCA (2.0 Vp-p, 1 kΩ)		
Video / Audio output			
VGA output	1-ch, resolution: 1280 × 1024 / 60 Hz, 1024 × 768 / 60 Hz		
CVBS output	2-ch, BNC connector (1.0 Vp-p, 75 Ω); Resolution: PAL: 704 × 576, NTSC: 704 × 480		
Audio output	1-ch, RCA connector (linear, 1 kΩ)		
Recording resolution	4CIF / 2CIF / CIF		
Frame rate	Main stream:	Main stream:	Main stream:
	4CIF / 2CIF: 12 fps	4CIF / 2CIF: 8 fps	4CIF / 2CIF: 6 fps
	Sub stream: CIF / QCIF @ up to 25 fps (P) / 30 fps (N)		
Video bit rate	32 kbps ~ 2048 kbps, or user defined (max. 3072 kbps)		
Stream type	Video, Video & Audio		
Audio bit rate	64 kbps		
Dual-stream	Support		
Synchronous playback	4-ch	8-ch	16-ch
Hard disk			
SATA	1 SATA interface	2 SATA interfaces	2 SATA interfaces
Capacity	Up to 2TB capacity for each disk		
External interface			
Network interface	1 RJ45 10M / 100M self-adaptive ethernet interface		
Serial interface	1 RS-485 interface, 1 RS-232 interface		
USB interface	2, USB 2.0		
Alarm in	4	8	16
Alarm out	1	4	4
General			
Power supply	12 VDC		
Consumption	≤ 10W (without hard disk or DVD-R/W)	≤ 10W (without hard disk or DVD-R/W)	≤ 15W (without hard disk or DVD-R/W)
Working temperature	-10°C ~ +55°C		
Working humidity	10% ~ 90%		
Chassis	Stand-alone 1U chassis	19-inch standard rack-mounted 1U chassis	19-inch standard rack-mounted 1.5U chassis
Dimensions (W x D x H)	315 × 230 × 45 mm	445 × 290 × 45 mm	445 × 390 × 70 mm
Weight	≤ 2kg (without hard disk or DVD-R/W)	≤ 4kg (without hard disk or DVD-R/W)	≤ 8kg (without hard disk or DVD-R/W)